

# HX400S

## Payload 400Kgf

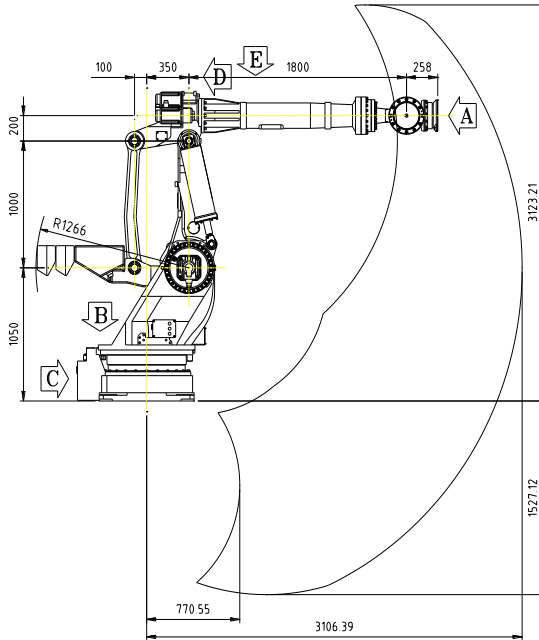

**View A: Detailed drawing of the wrist attachment part**

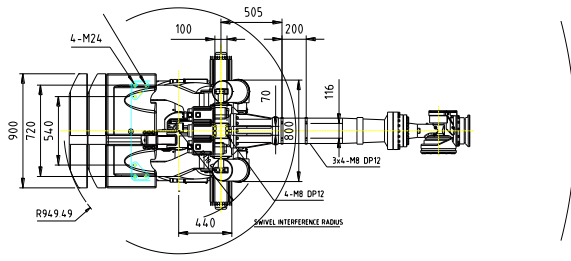
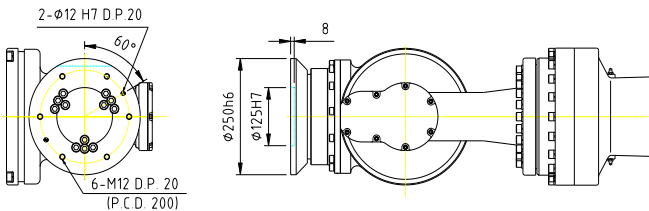

**View B: Dimensional drawing for the floor installation of the body**

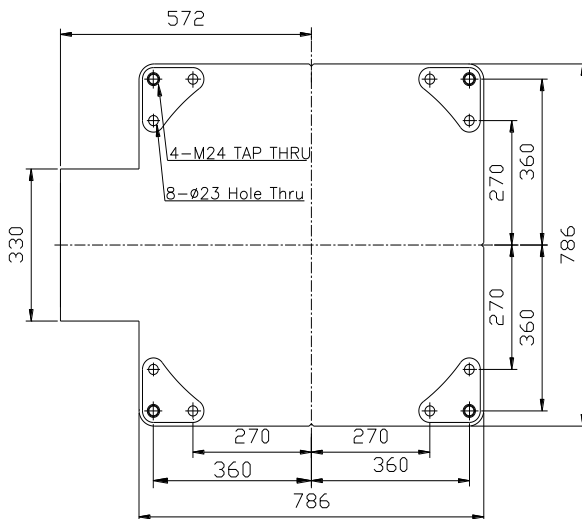

**View C: Application cable connection part (Option)**

**View D: Application cable connection part (Option)**

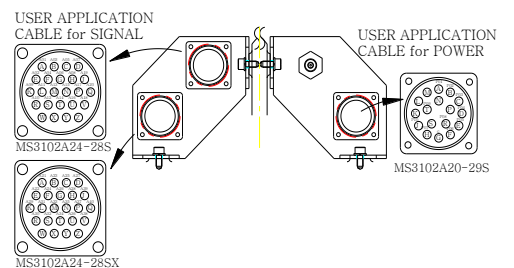

**View E: Details of the application ancillary part attachment**

Installation method	
Floor	
Ceiling	
Wall	
Shelf	●

Application	
Spot Welding	●
Arc Welding	
Handling	●
Assembly	
Sealing	●

Item	Specification		
Robot model	HX400S		
Payload	400Kg		
Structure	Articulated		
Degree of freedom	6 axes		
Drive system	AC SERVO MOTOR		
Max. working envelope	A r m S	±3.142 rad (±180°)	
	H	+1.658 ~ -0.872rad(+95° ~ -50°)	
	V	+1.047 ~ -1.047rad(+60° ~ -60°)	
	Wrist	R2	±6.283 rad (±360°)
		B	±2.094 rad (±120°)
Max. working speed	A r m S	1.484 rad / s (85° / s)	
	H	1.484 rad / s (85° / s)	
	V	1.484 rad / s (85° / s)	
	Wrist	R2	1.745 rad / s (100° / s)
		B	1.745 rad / s (100° / s)
Wrist torque	R2	1960 N-m (200Kgf-m)	
	B	1960 N-m (200Kgf-m)	
	R1	823 N-m (84Kgf-m)	
Accuracy of position repeatability	±0.08 mm		
Ambient Temperature	0 ~ 45C (273 ~ 318 K)		
Robot's Weight	2910 Kg		
Working envelope section area	5.89 m <sup>2</sup>		

\*\* For product improvement, some of the ratings, specifications, dimensions, etc. are subject to changes without notice.